

KTD22.2-62

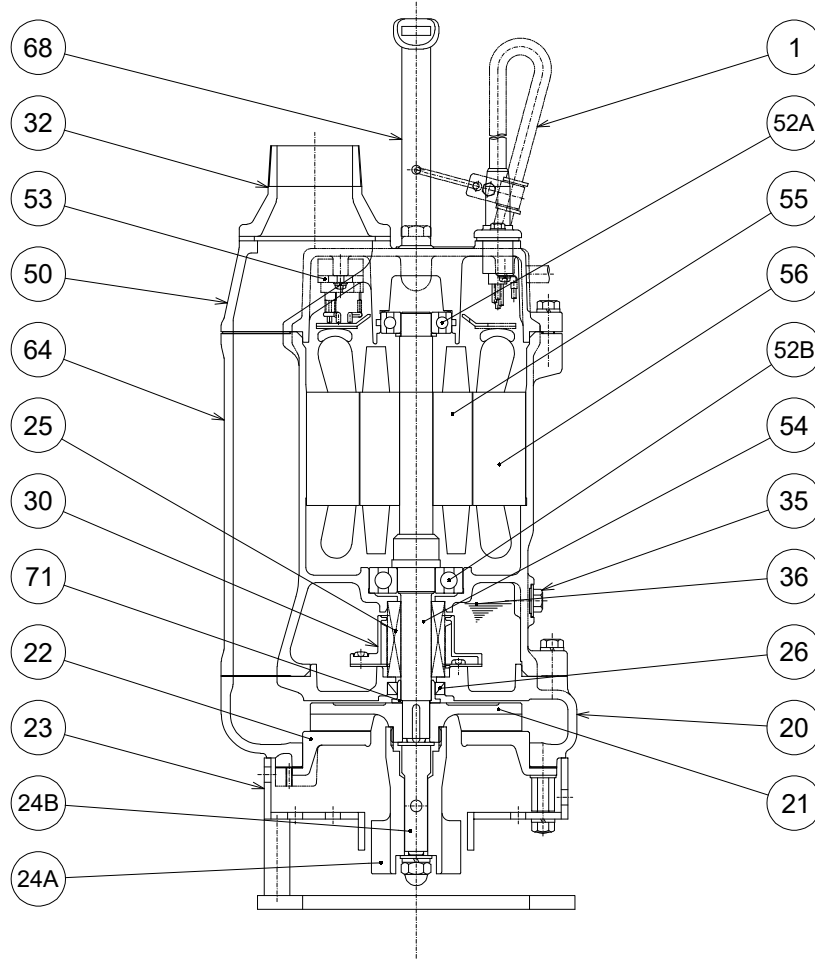

PART#	DESCRIPTION	MAIN MATERIAL / NOTE	RELATED RELATED ASTM, AISI CODE	RELATED EN CODE	QTY
1	Power Cable	PVC Sheath AWG 16/4-50ft			1
20	Pump Casing	Cast Iron	A48M Class30B	EN 1561 GJL-200	1
21	Impeller	High Chrome Cast Iron	A532 Class III Type A	DIN 1695 G-X260Cr27	1
22	Suction Cover	Ductile Cast Iron	A536 80-55-06	EN 1563 GJS-500-7	1
23	Strainer Stand	Steel + Carbon Steel Pipe	A283 Grade D + A53 Type F	EN 10025 S275 + DIN 1615 St33	1
24A	Agitator	Ductile Cast Iron (Hardened)	A536 100-70-03	EN 1563 GJS-700-2	1
24B	Clutch	Carbon Steel	AISI 1035	EN 10083-2 C35 (1.0501)	1
25	Mechanical Seal	Silicon Carbide / H-20T			1
26	Oil Seal	NBR / TC25388			1
30	Oil Lifter	PBT Resin			1
32	Discharge Connection	Cast Iron / NPT 2"	A48M Class30B	EN 1561 GJL-200	1
35	Oil Plug	Stainless Steel	S 30400	1.4301	1
36	Lubricant	Turbine Oil ISO VG32 or SAE10W-20			
50	Motor Head Cover	Cast Iron	A48M Class25B	EN 1561 GJL-150	1
52A	Upper Bearing	#6204ZC3			1
52B	Lower Bearing	#6305ZC3			1
53	Motor Protector				1
54	Shaft	Stainless Steel	S 42000	1.4028	1
55	Rotor				1
56	Stator				1
64	Motor Housing	Cast Iron	A48M Class25B	EN 1561 GJL-150	1
68	Handle	Steel (Cold Rolled) + NBR	A109 / A1008	EN 10130	1
71	Shaft Sleeve	Stainless Steel	S 30400	1.4301	1